

ECD DETECTOR

Installation

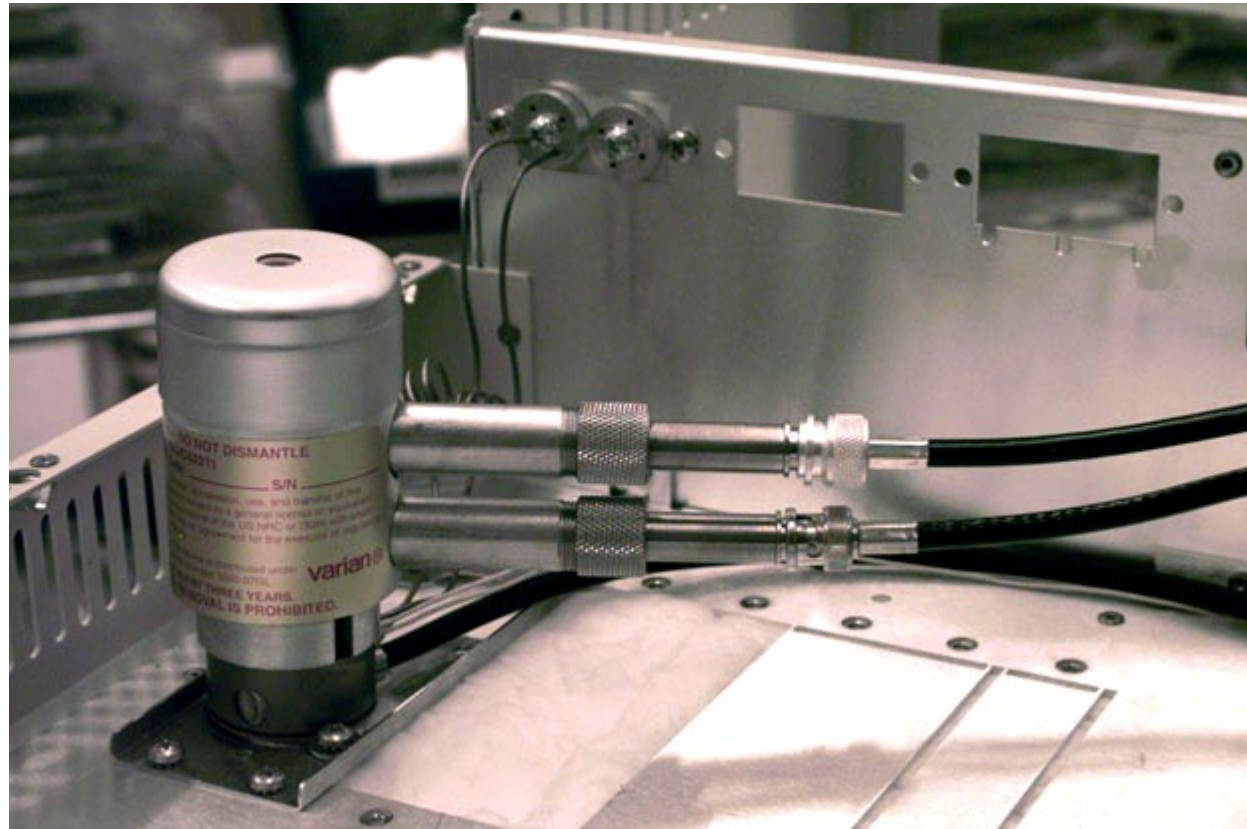

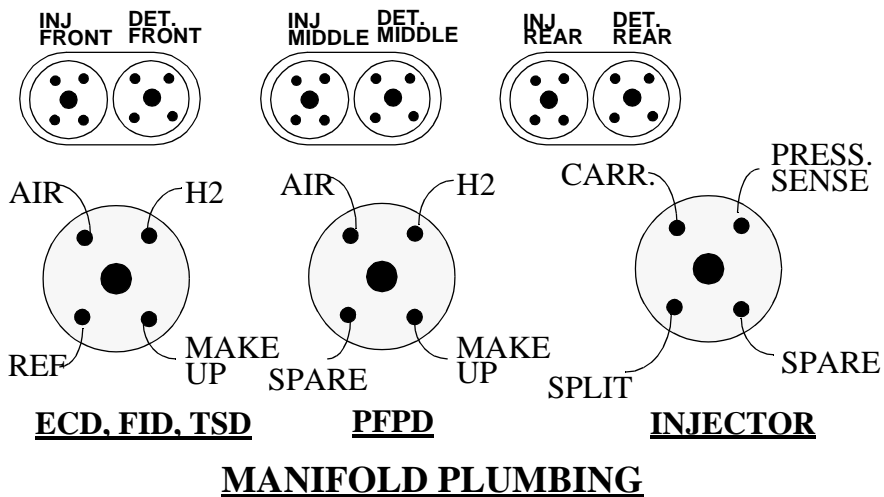

03-917142-00
VITON FERRULE

12-901150-00
SCREW

03-917141-00
CONDYNE PLATE

REF.
ONLY

TOP
LINE FROM
DET. BASE,

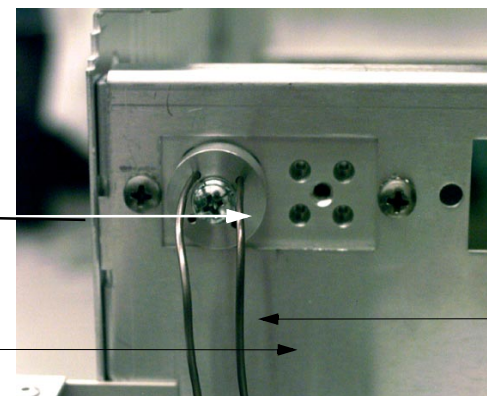

BOTTOM
LINE FROM
DET. BASE,

DETECTOR SIDE MANIFOLD

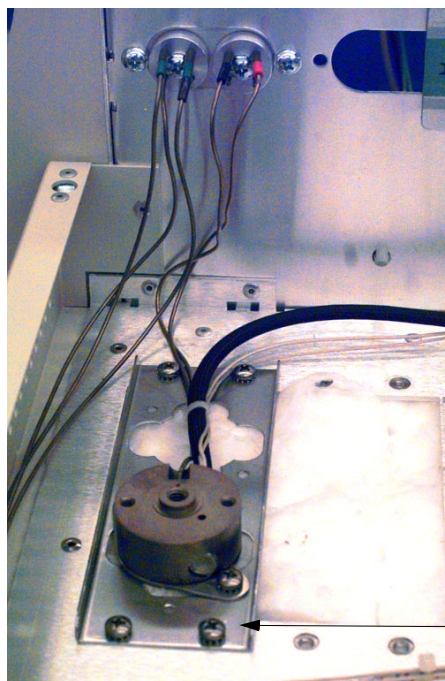

12-901163-00
SCREW, 4EA

DETECTOR BASE MOUNTING

03-925374-01
TEMPERATURE PROBE

03-925396-01
120V HTR. ION

03-925396-02
220V HTR. ION

03-925396-03
101V HTR. ION

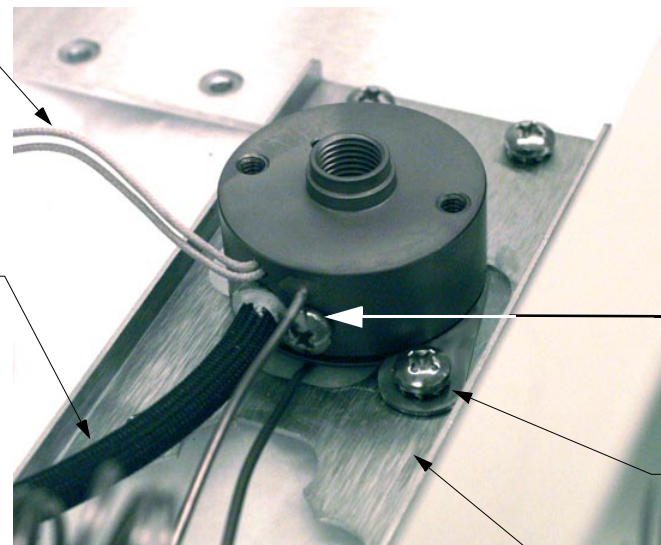

12-901165-00
SCREW

12-901163-00
SCREW, 2EA

-03-925526-01
DETECTOR BASE CLIP

03-925326-01
DETECTOR MOUNTING BASE

[CLICK HERE FOR PROBE CONNECTION TO J41 ON POWER BOARD](#)

[CLICK HERE FOR HEATER CONNECTION J7 ON MAIN BD.](#)

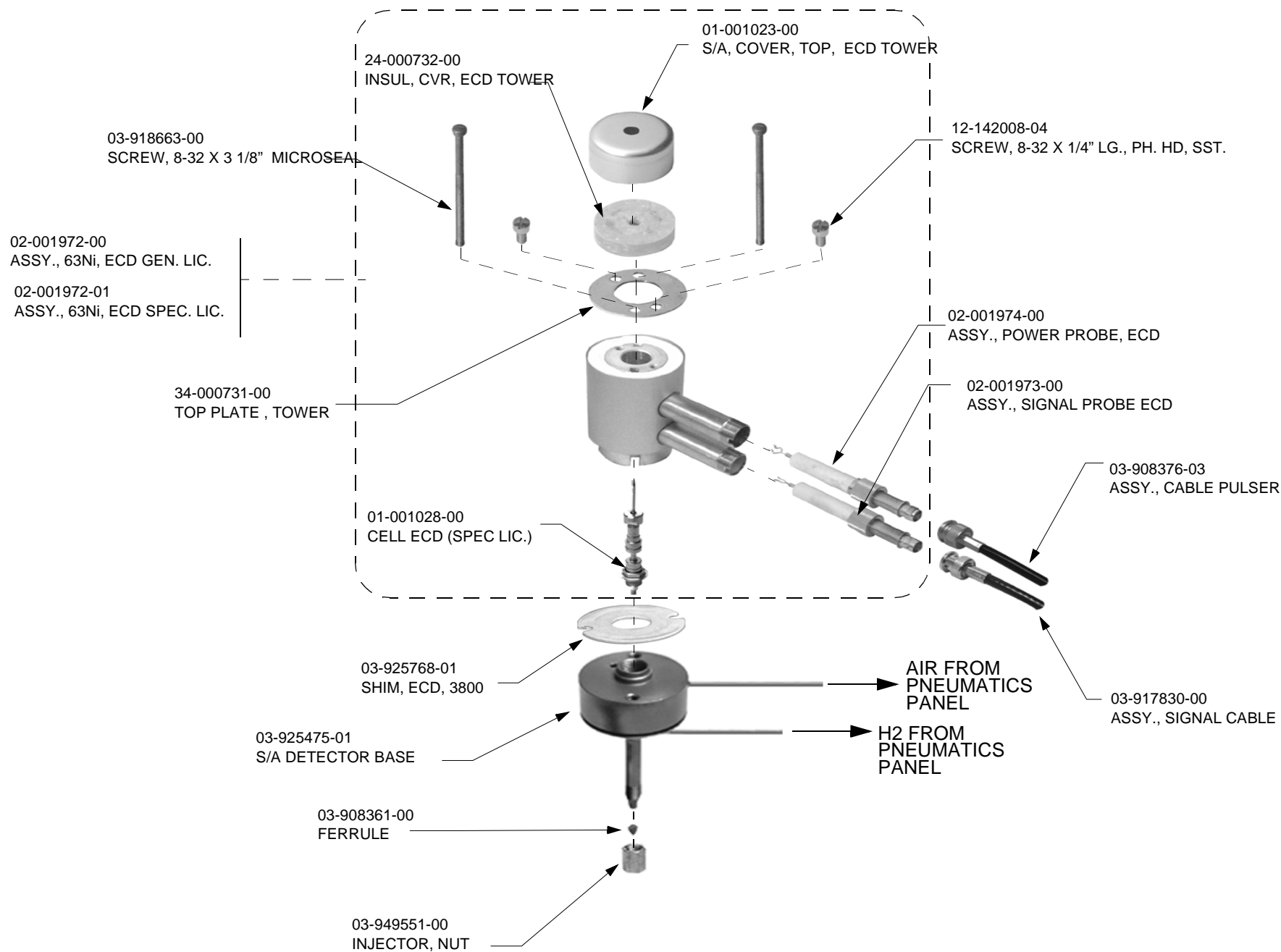

03-918853-04
PEEK TUBING, BLUE, MAKE UP IN

12-222008-05
SCREW 2EA.

03-918853-04
PEEK TUBING, BLUE, MAKE-UP TO MANIFOLD

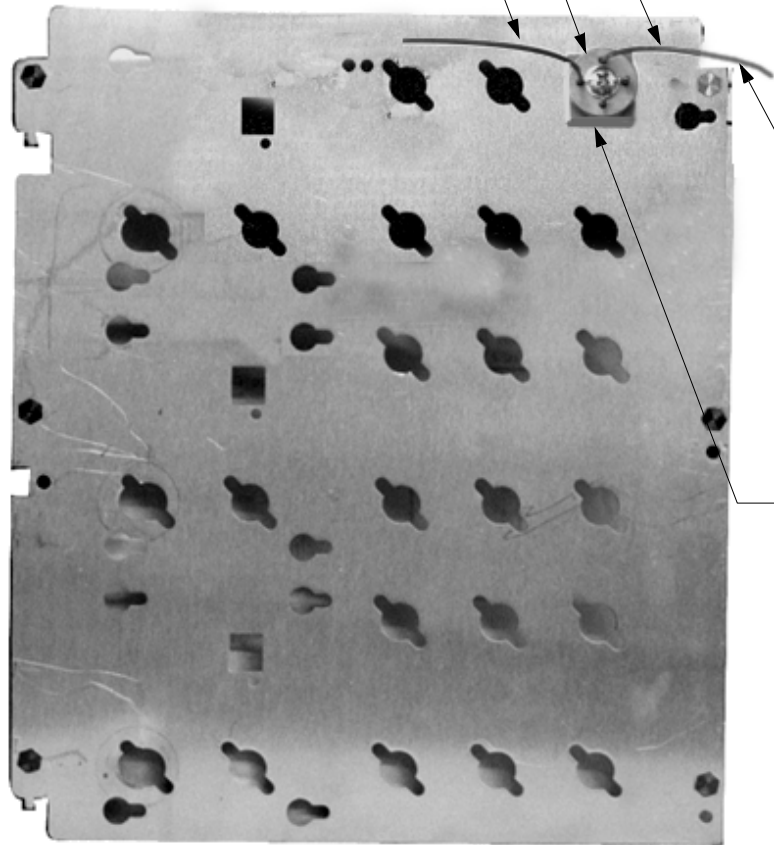

**MAKE-UP
INLET**

03-917142-00
VITON FERRULE

12-901150-00
SCREW

03-917141-00
CONDYNE PLATE

REF.
ONLY

REFERENCE ONLY
PNEU. MANIFOLD

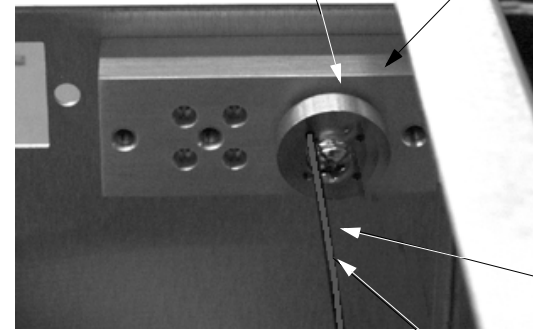

HYDROGEN LINE
FROM PNEU PANEL
TO DETECTOR RED

03-918853-04
PEEK TUBING, BLUE MAKE-UP

PNEUMATICS SIDE MANIFOLD

03-917065-01
VALVE, COMB-S, RED, HYDROGEN

PNEUMATICS PANEL

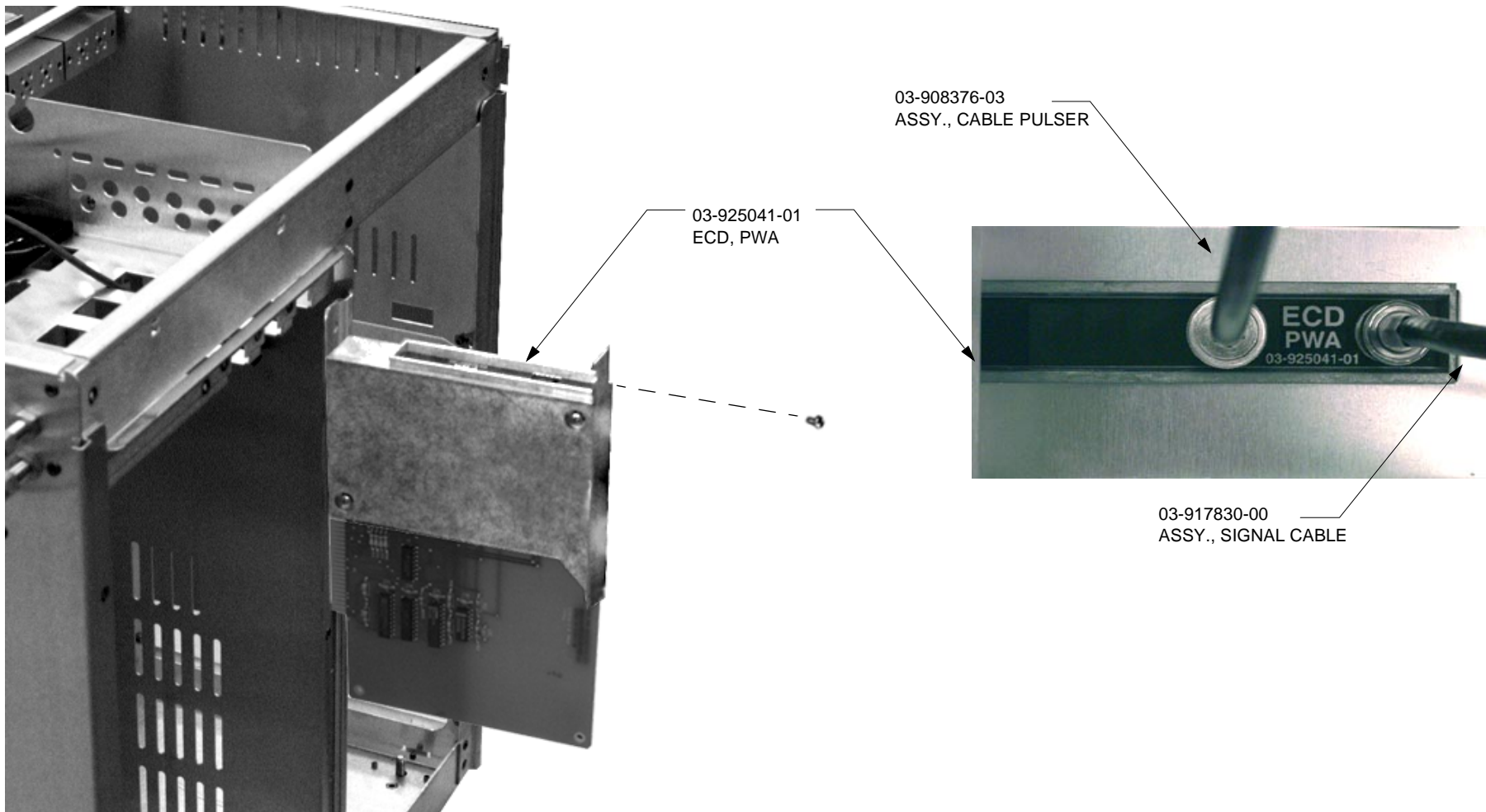

PARTS NOT SHOWN

NOTE: POSITION & ROUTING OF CABLE AND TIES NOT SHOWN. DRESS CABLE W/ QTY. NEEDED USING AVAILABLE SPACE.

22-300001-00
CLAMP, CABLE , STANDOFF